

**TO: Honorable Mayor and City Council**

**FROM: City Administrator Ron Johnson**

**SUBJECT: Adopt Resolution Approving Withholding of Sale of Tax-Forfeited Parcel 52.456.0090**

**DATE: August 30, 2016**

**BACKGROUND**

At the August 16, 2016 meeting, City Council approved a motion requesting that Goodhue County withhold the sale of tax-forfeited parcel 52.456.0090 for six-months to allow for continued planning within the Sandstone Ridge subdivision. Goodhue County has since requested that Council approve this by resolution.

The following is a summary of information in the last meeting packet related to this: *Southeast MN Multi-County Housing and Redevelopment Authority (SEMMCHRA) continues to look into the potential development of Sandstone Ridge.*

*Their staff met with county and city staff on August 10 to review a feasibility report of redeveloping Sandstone Ridge prepared for SEMMCHRA by Stantec Consulting Services.*

*During this meeting, I shared this letter from Goodhue County informing that another parcel in the Sandstone Ridge Subdivision was forfeited to the State of MN for non-payment of taxes. We discussed the importance of maintaining control of this parcel while planning is being conducted. It was agreed that it could be harmful to any potential project in this area if this parcel/outlot was purchased by a private party.*

*The main storm sewer and sewer main into the Sandstone subdivision extend through this parcel.*

**REQUESTED COUNCIL ACTION**

Approve a motion adopting a Resolution Requesting that Goodhue County Withhold the Sale of Tax-Forfeited Parcel 52.456.0090 for six-months to allow for continued planning within the Sandstone Ridge subdivision.

Attachment(s): Resolution; Maps

**CITY OF CANNON FALLS  
GOODHUE COUNTY, MINNESOTA**

**RESOLUTION NUMBER 2215**

**A RESOLUTION APPROVING REQUEST TO WITHHOLD SALE  
OF TAX-FORFEITED PARCEL 52.456.0090**

**WHEREAS**, Southeast MN Multi-County Housing and Redevelopment Authority (SEMMCHRA) continues to look into the potential development of Sandstone Ridge, and

**WHEREAS**, SEMMCHRA staff met with Goodhue County and city of Cannon Falls staff on August 10 to review a feasibility report of redeveloping Sandstone Ridge prepared for SEMMCHRA by Stantec Consulting Services, and

**WHEREAS**, parcel 52.456.0090 is a non-conservation parcel of land located in Sandstone Ridge Subdivision, and

**WHEREAS**, parcel 52.456.0090 was forfeited to the State of Minnesota for non-payment of property taxes, and

**WHEREAS**, future development of Sandstone Ridge could be jeopardized by a sale at auction of parcel 52.456.0090;

**NOW, THEREFORE, BE IT RESOLVED BY THE CITY COUNCIL OF CANNON FALLS, MINNESOTA** to hereby request that Goodhue County withhold the sale of tax-forfeited parcel 52.456.0090 for six-months to allow for continued planning within the Sandstone Ridge subdivision.

**ADOPTED** by the Council this 6th day of September, 2016.

CITY OF CANNON FALLS

By: \_\_\_\_\_  
Lyman M. Robinson, Mayor

ATTEST: \_\_\_\_\_  
Ronald S. Johnson, City Administrator

# ArcGIS WebMap

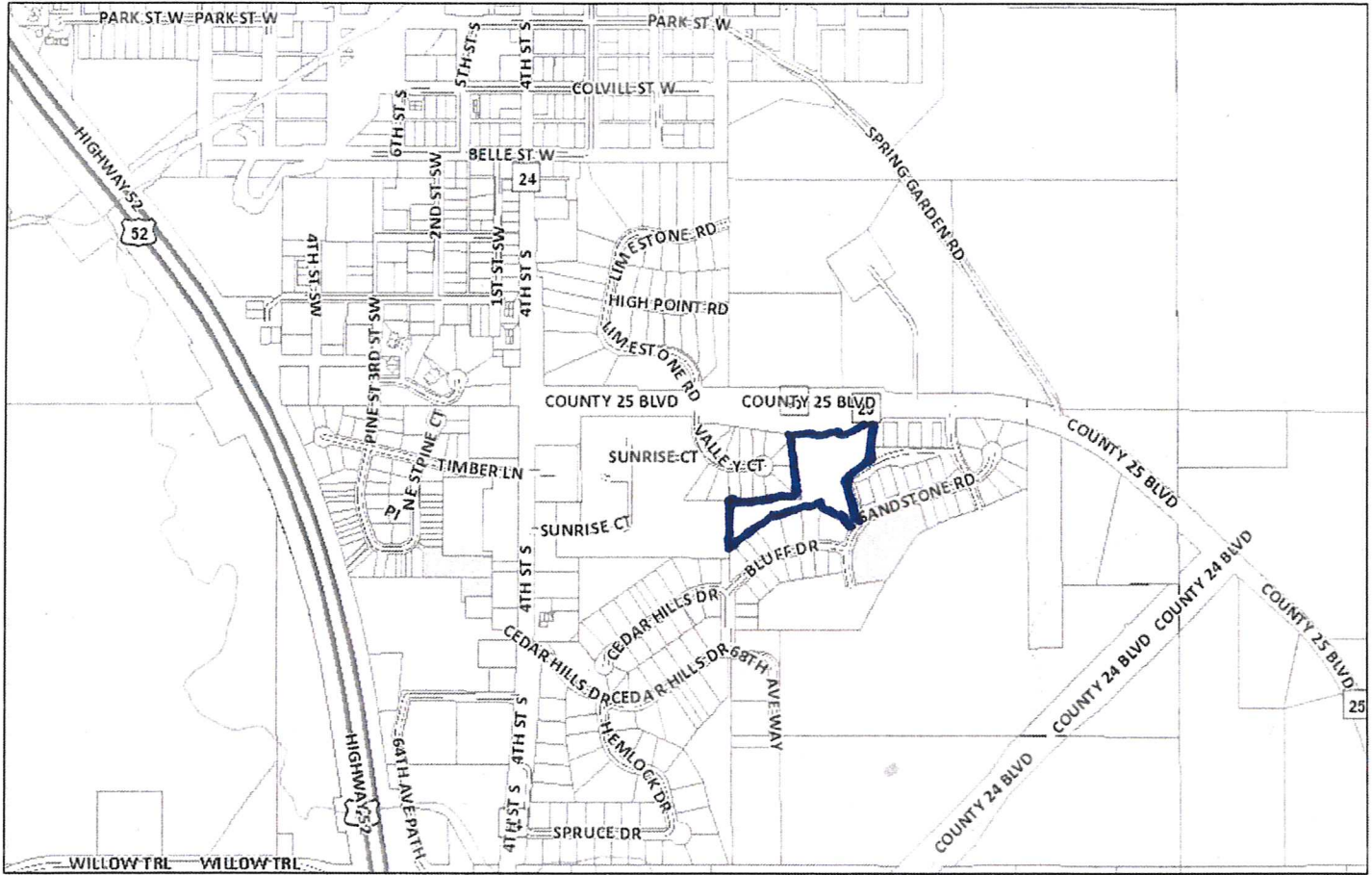

August 16, 2016

- |                          |                       |                         |                  |
|--------------------------|-----------------------|-------------------------|------------------|
| <b>Roads 9,600</b>       | State Highway         | Roads 9,600             | ESRI Major Roads |
| Township or Other Roads  | County Roads 9,600    | Township or Other Roads | Parcels          |
| <b>Major Roads 9,600</b> | County Roads - Gravel | Roads 9,600             |                  |
| US Highway               | County Roads - Paved  | Township or Other Roads |                  |

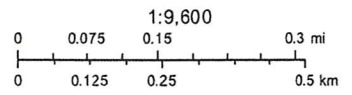

# ArcGIS WebMap



January 13, 2016

Search Results: Search by PIN Roads 9,600

Override 1

Municipal Boundary

Township or Other Roads

Full Address

PIN

Name

GoodhueCo\_PLSS County Roads 2,400

Major Roads 2,400

US Highway

State Highway

County Roads - Gravel

County Roads - Paved

1:1,560

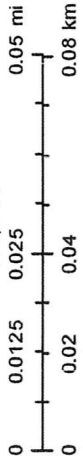

Goodhue County