

**CITY OF CANNON FALLS  
GOODHUE COUNTY, MINNESOTA**

**RESOLUTION NUMBER 2591**

**A RESOLUTION APPROVING MUNICIPAL CONSENT PROJECT  
NO. SAP 025-622-002, ALONG COUNTY STATE-AID HIGHWAY NO. 22**

WHEREAS, plans for Project No. SAP 025-622-002 showing proposed alignment, profiles grades and cross-sections for the construction, reconstruction or improvement of County State-Aid Highway No. 22 within the limits of the City of Cannon Falls as a State Aid Project have been prepared and presented to the City.

NOW, THEREFORE, BE IT RESOLVED: That said plans be in all things approved.

**ADOPTED BY THE CITY COUNCIL OF THE CITY OF CANNON FALLS ON THIS 16<sup>th</sup> DAY OF  
NOVEMBER, 2021.**

**SIGNED:**

\_\_\_\_\_  
John O. Althoff, Mayor

**ATTEST:**

\_\_\_\_\_  
Neil L. Jensen, City Administrator

**CERTIFICATION**

State of Minnesota  
County of Goodhue

I hereby certify that the foregoing Resolution is a true and correct copy of a resolution presented to and adopted by the City Council of Cannon Falls at a meeting therefor held in the City of Cannon Falls, Minnesota, on the 16<sup>th</sup> day of November, 2021, as disclosed by the records of said City in my possession.

\_\_\_\_\_  
Neil L. Jensen, City Administrator

(Seal)

**LEGEND**

**ROAD AND ROADWAY FEATURES**

- PROJECTED ROAD
- PRIMITIVE ROAD
- UNIMPROVED ROAD
- GRADED AND DRAINED ROAD
- SOIL SURFACE ROAD
- GRAVEL OR STONE ROAD
- BITUMINOUS ROAD
- PAVED ROAD
- DIVIDED ROAD

**ROAD SYSTEM DESIGNATIONS**

- INTERSTATE TRUNK HIGHWAY
- U.S. NUMBERED TRUNK HIGHWAY
- STATE NUMBERED TRUNK HIGHWAY
- COUNTY STATE AID HIGHWAY
- COUNTY ROAD
- COUNTY STATE AID IN ADJOINING COUNTY
- TERMINATION OF DESIGNATED ROUTE
- INTERSTATE EXIT
- GREAT RIVER ROAD
- FEDERAL AID INTERSTATE SYSTEM
- NATIONAL FOREST HIGHWAY
- NATIONAL FOREST DEVELOPMENT
- INDIAN SERVICE ROAD
- STATE FOREST ROAD
- STATE PARK ROAD
- F.A.I.
- N.F.H.
- N.F.D.
- I.S.
- S.F.R.
- S.P.R.

**STRUCTURES**

General Symbols (over 20' span)

- HIGHWAY BRIDGE
- SMALL BRIDGES CLOSELY SPACED
- DRAWBRIDGE

**DRAINAGE**

- INTERMITTENT STREAM
- NARROW STREAM
- WIDE STREAMS
- MARSH OR SWAMP LAND
- DRAINAGE DITCH
- LAKE OR POND

**BOUNDARIES**

- NATIONAL OR STATE COUNTY
- CIVIL TOWNSHIP
- CONGRESSIONAL TOWNSHIP (U.S. LAND)
- CORPORATE LINE
- SECTION LINE
- CONGESTED AREA
- NATIONAL OR STATE PARK
- NATIONAL OR STATE FOREST
- INDIAN RESERVATION
- GAME REFUGE
- AIRPORT
- WILDLIFE MANAGEMENT AREA (STATE) OR WATERFOWL AREA (FEDERAL)
- MATCH LINE BETWEEN ADJOINING SHEETS OF THE SAME COUNTY

**UTILITY**

- UNDERGROUND CABLE PEDESTAL
- BURIED ELECTRIC CABLE
- BURIED TELEPHONE CABLE
- BURIED FIBER OPTIC CABLE
- GAS LINE
- WATER LINE
- VALVE
- FIRE HYDRANT
- MANHOLE

FOR MORE PLANS AND UTILITIES SYMBOLS SEE TECHNICAL MANUAL

**DESIGN DESIGNATION**

CSAH 22 STA. 10+50 to STA. 22+08

FUNCTIONAL CLASS	MINOR COLLECTOR
SHOULDER WIDTH	8'
R-VALUE	50
ADT (CURRENT YEAR)	2022 = 743
ADT (FUTURE YEAR)	2042 = 832
D (DIRECTIONAL DISTR.)	50/50 %
T (HEAVY COMMERCIAL)	4 %
TON DESIGN	10
N18 92,982 (20 YEAR FLEXIBLE DESIGN)	

MINNESOTA DEPARTMENT OF TRANSPORTATION

**GOODHUE COUNTY**

C.S.A.H. 22

**CONSTRUCTION PLAN FOR BITUMINOUS MILLING, BITUMINOUS SURFACING, AND BITUMINOUS SHOULDER**

LOCATED ON C.S.A.H. 22 BETWEEN T.H. 20 AND C.S.A.H. 17

MN. PROJ NO.

**GOVERNING SPECIFICATIONS**

THE 2020 EDITION OF THE MINNESOTA DEPARTMENT OF TRANSPORTATION "STANDARD SPECIFICATIONS" FOR CONSTRUCTION SHALL GOVERN

**INDEX**

1. TITLE SHEET
2. ESTIMATED QUANTITIES, STANDARD PLATES AND NOTES
3. TYPICAL SECTIONS

THIS PLAN CONTAINS 3 SHEETS

DESIGN ENGINEER: I HEREBY CERTIFY THAT THIS PLAN WAS PREPARED BY ME OR UNDER MY DIRECT SUPERVISION, AND THAT I AM A DULY LICENSED PROFESSIONAL ENGINEER UNDER THE LAWS OF THE STATE OF MINNESOTA.

SIGNATURE *Jess Greenwood*  
JESS GREENWOOD - GOODHUE COUNTY DESIGN ENGINEER

DATE 26 OCT 2021 LIC. NO. 49150

*Angela Sabara* 26 OCT 21  
APPROVED GOODHUE COUNTY ENGINEER DATE

DISTRICT STATE AID ENGINEER: REVIEWED FOR COMPLIANCE WITH STATE-AID RULES/POLICIES DATE

STATE AID ENGINEER: APPROVED FOR STATE AID AND FEDERAL AID FUNDING DATE

PLAN REVISIONS		
DATE	SHEET NO.	APPROVED BY

I HEREBY CERTIFY THAT THE FINAL FIELD REVISIONS, IF ANY, OF THIS PLAN WERE MADE BY ME OR UNDER MY DIRECT SUPERVISION AND THAT I AM A DULY LICENSED PROFESSIONAL ENGINEER UNDER THE LAWS OF THE STATE OF MINNESOTA.

DATE LIC. NO.

① STATE AID PROJECT NO. 025-622-002 (EIGHTH STREET)

GROSS LENGTH	1380.00 FEET	0.261 MILES
BRIDGES-LENGTH	0 FEET	0 MILES
EXCEPTIONS-LENGTH	0 FEET	0 MILES
NET LENGTH	1380.00 FEET	0.261 MILES

② STATE AID PROJECT NO. 025-622-002 (ST. CLAIR STREET)

GROSS LENGTH	1150.00 FEET	0.218 MILES
BRIDGES-LENGTH	0 FEET	0 MILES
EXCEPTIONS-LENGTH	23.00 FEET	0 MILES
NET LENGTH	1127.00 FEET	0.213 MILES

**Legal Description**

FROM: 1320ft NORTH AND 1487ft WEST OF THE NORTH QUARTER CORNER SECTION 18, T112, R17W.

TO: 2000ft EAST OF THE WEST QUARTER CORNER SECTION 7, T112N, R17W.

③ NON-PARTICIPATING EIGHTH STREET

GROSS LENGTH	239.54 FEET	0.045 MILES
BRIDGES-LENGTH	0 FEET	0 MILES
EXCEPTIONS-LENGTH	0 FEET	0 MILES
NET LENGTH	159.00 FEET	0.045 MILES

**GOODHUE COUNTY**

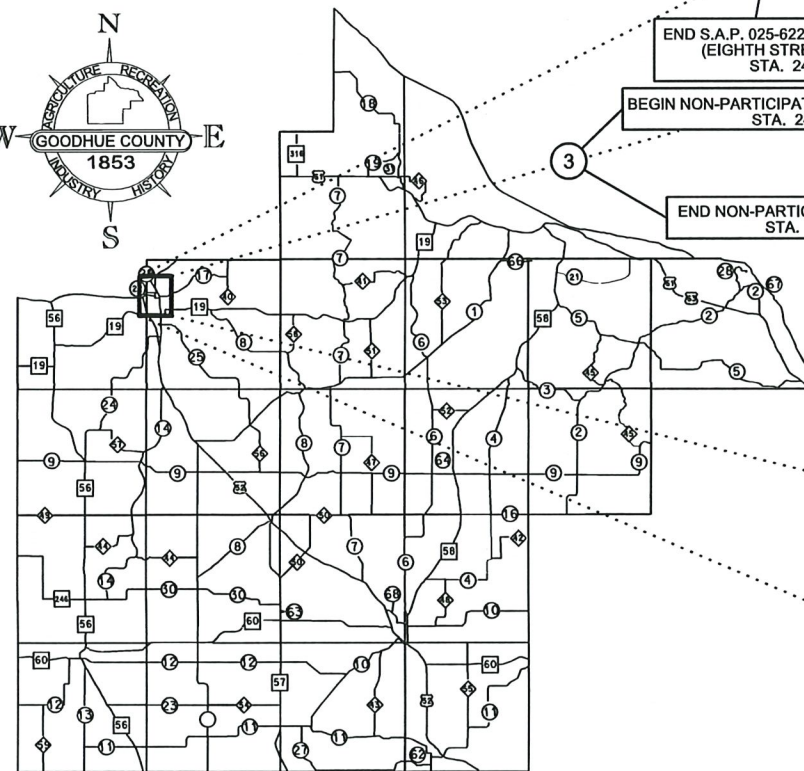
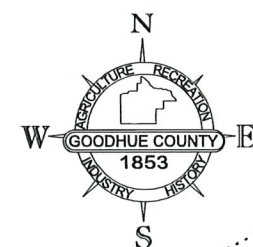

- 85 - U.S. HIGHWAY
- 56 - STATE HIGHWAY
- 4 - COUNTY STATE AID HIGHWAY
- 4 - COUNTY ROAD

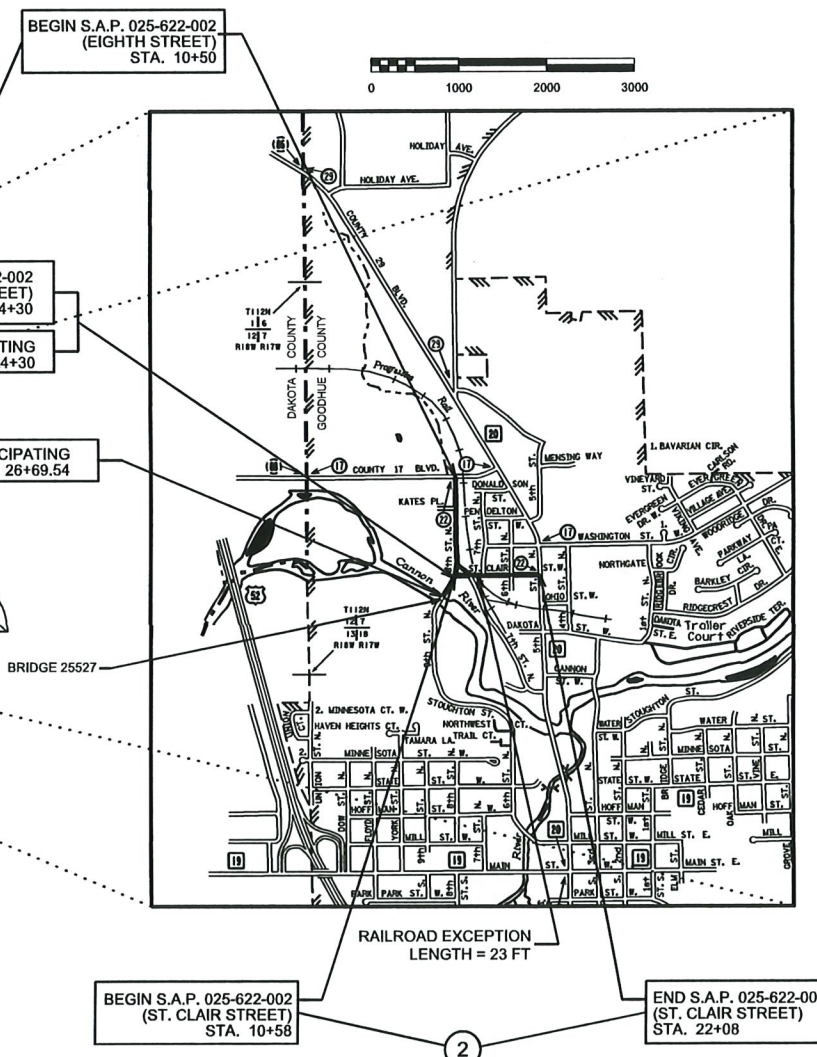

FOR PLANS AND UTILITIES SYMBOLS SEE TECHNICAL MANUAL

STATE PROJ. NO. CHARGE IDENTIFIER

PROJECT LOCATION SCALES

COUNTY : GOODHUE PLAN 100'  
DISTRICT : 6 PROFILE 100' HORIZ. 10' VERT.

S.A.P. NUMBER 025-622-002 (C.S.A.H. 22) SHEET NO. 1 OF 3 SHEETS

27-OCT-2021 07:26

PLOTTED/REVISED:

MODEL sheet for pdf

PATH & FILENAME: P:\CO.ROADS\22CSAH\622-002 2022Paving\cover-t112-22.dgn

ESTIMATED QUANTITIES						
NOTES	ITEM NO.	ITEM	UNIT	PARTICIPATING	NON-PARTICIPATING	TOTAL QUANTITY
	2021.501	MOBILIZATION	LS	.90	.10	1
	2232.504	MILL BITUMINOUS SURFACE 2" (P)	SY	12211	1119	13330
	2357.506	BITUMINOUS MATERIAL FOR TACK COAT	GAL	977	90	1067
1	2360.509	TYPE SP 12.5 WEARING COURSE MIXTURE (2,C)	TON	1405	129	1534
	2504.602	ADJUST VALVE BOX	EA	7	0	7
	2506.522	ADJUST FRAME & RING CASTINGS	EA	6	0	6
	2563.601	TRAFFIC CONTROL	LS	.90	.10	1
	2582.503	4" SOLID LINE YELLOW - PAINT	LF	1744	0	1744

**NOTES:**

- 1. THIS QUANTITY INCLUDES 113 TONS FOR APPROACHES TO BE PLACED IN CONJUNCTION WITH MAINLINE PAVING.

**UTILITY INFORMATION**

THE SUBSURFACE UTILITY INFORMATION IN THIS PLAN IS UTILITY QUALITY LEVEL D. THIS QUALITY LEVEL WAS DETERMINED ACCORDING TO THE GUIDELINES OF CI/ASCE 38-2, ENTITLED "STANDARD GUIDELINES FOR THE COLLECTION AND DEPICTION OF EXISTING SUBSURFACE UTILITY DATA".

**BASIS FOR ESTIMATED QUANTITIES:**

WEARING COURSE MIXTURE 115 LB / SQ.YD. / IN  
 BITUMINOUS MATERIAL FOR TACK COAT .08 GAL / SQ. YD.

**STANDARD PLATES**  
 THE FOLLOWING STANDARD PLATES, APPROVED BY THE FEDERAL HIGHWAY ADMINISTRATION, SHALL APPLY

PLATE NO.	DESCRIPTION
4108F	ADJUSTING RINGS FOR CATCH BASINS & MANHOLES
8000K	CHANNELIZERS
9000E	APPROACHES AND ENTRANCES

PATH & FILENAME: P:\CO.ROADS\22CSAH\622-002 2022Paving\Typ Section22.dgn MODEL TYP22-SECTIONS PLOTTED/REVISED: 01-NOV-2021 10:09

Sta. 10+50 to Sta 22+08  
 Proposed Gravel Equivalent = 18.0"  
 According to MnDot Standards (2022)  
 Sta. 0+00 to Sta. 212+22  
 (CSAH 9 to 343rd Street)  
 Project year ADT = 832  
 20 Year Design Flexible ESAL = 92,982  
**Required Gravel Equivalent = 10.0"**

**TYPICAL SECTION CSAH 22 Sta. 10+50.00 to Sta. 22+08.00**     **TYPICAL SECTION 8th Street Sta. 24+30.00 to Sta. 25+89.00**  
 BETWEEN T.H. 20 AND C.S.A.H. 17     BETWEEN CSAH 22 AND BRIDGE 25527  
 WIDTH TAPERS FROM 40' TO 31'

